



Unity
Signet
Banashankari





Company registered under companies act, 1956
and in the field of construction for the past 4
years. The company is incorporated with the
main objects of Property Development,
Construction of Apartments, Commercial
Complexes & Residential Layout Project in
response to the growing need for quality housing
in Bangalore, Hubli, Dharwad & Belgaum.



*Ongoing Project at Jayanagar
5th Block*



*Proposed Project at Banashankari
Unity Signet Block B*



*Proposed Project at Banashankari
Unity Signet Block C*





Unity
Signet
Banashankari

is centrally located in Banashankari 2nd Stage, South Bangalore. Everything you've envisioned for your dream home has been designed and materialized at "UNITY SIGNET" to turn your wishes in to your Lifestyle. Designed with modern contemporary style of Architecture, the apartments range from 950 to 1900 sq.ft.

Outlined with luxury.

The Unity Signet surrounded with many Shopping malls, Educational institutions, Reputed Hospitals, Restaurants, Namma Metro Station & Parks

Unity Signet is everything you need for Happy Day & Happy Home.

Ground Floor Plan



Ground Floor

Flat No	SBA	Facing	BHK
101	1250	North	3
102	950	East	2

First & Second Floor Plan



First & Second Floor Plan

Flat No		SBA	Facing	BHK
First Floor	Second Floor			
201	301	1250	North	3
202	302	950	East	2

Third Floor Plan



Third Floor

Flat No	SBA	Facing	BHK
401	1250	North	3
402	1900	East	3

Fourth Floor Plan



Parking
Basement / Stilt Level

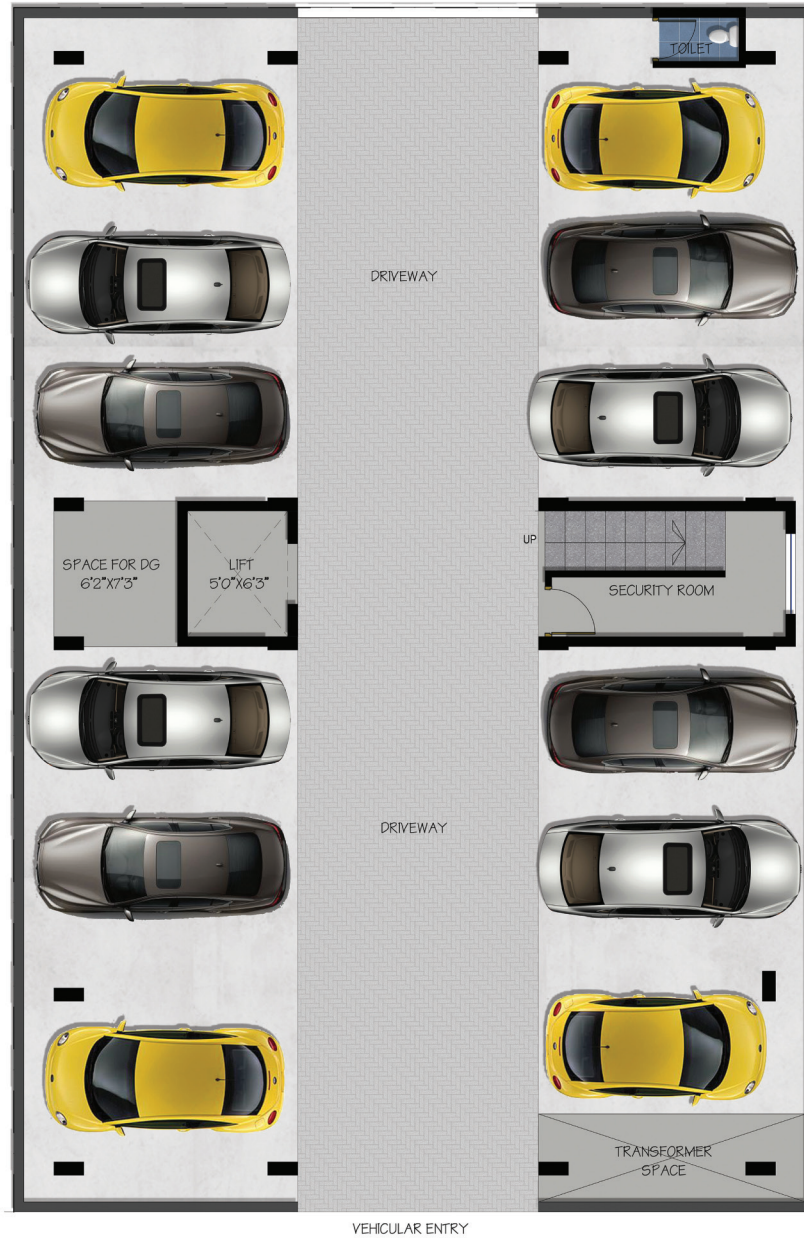

VEHICULAR ENTRY

STILT FLOOR



Architectural/civil Specification

Architectural/civil Specification

- 8 No's of exclusively designed 2 +Study room 3 BHK apartments

Structure

- Stilt/Basement + Ground+ 3.5 storied RCC Structure

Car Parking

- Covered car parks in Stilt/Basement level

Foyer/ Living/ Dining

- Foyer & Living Vitrified flooring and skirting Plastic emulsion paint for walls and ceiling

Bedrooms

- Superior Quality wooden laminated flooring and skirting/equivalent flooring for master bedroom
- vitrified tile flooring and skirting in other bedrooms.
- Plastic emulsion paint for walls & ceiling

Toilets

- Superior Quality anti-skid ceramic tile flooring
- Superior Quality ceramic wall tiling up to false ceiling

Kitchen

- Natural/ Engineered stone slab/ vitrified tile flooring
- Superior quality ceramic tiling dado from floor to ceiling soffit
- Plastic emulsion paint for ceiling

Balconies/Utilities

- Superior quality anti-skid ceramic tile flooring & skirting
- Granite coping for parapet / Mild steel handrail/glass railing with MS andrail
- Plastic emulsion paint for ceiling

Staircase

- Concrete treads & riser's
- Textured paint for walls
- Plastic emulsion paint for ceiling & MS Handrail

Architectural/civil Specification

Common Area

- Vitrified tile / granite flooring
- Superior quality ceramic tile cladding up to ceiling
- Plastic emulsion for ceiling • Granite coping for parapet / MS handrail

Joinery

- Main Door / Bedroom Doors
- Frame - Timber
- Architrave - Timber
- Shutter- with both side Masonite skin

Toilet Door

- Frame- Timber
- Architrave - Timber
- Shutter - with mansonite outside & laminate inside

LIFTS

- Johnson 6 Passengers elevators/Equalent to this

Plumbing & Sanitary

- Sanitary fixtures of Jaguar or Equalent reputed make.
- Chromium plated fittings of reputed make.

Electrical Works

- Split AC provision in living room and all bedroomsBESCOM power supply: 3KW 3phase supply for 3BHK unit.
- Exhaust fans in kitchen and toilets
- Television Points living, Family, all bedrooms
- Telephone points in all bedroom, living & family Room

Amenities

- Intercom facility from security cabin to each apartment CC TV Camera, Centralized gas connection and Power Back up for Common areas



Route Map



Office Address # 9B, 1st floor, Srinidhi Complex,
24th Main Road, JP Nagar, 5th Phase, Bangalore-560078
Ph: 080-42162055 | Mob: 9663235353

www.unityinfrastructure.in

Site Address: No 1798, 13th Main, 34th Cross, Banashankari 2nd Stage, Bangalore – 560 070
