



# Banashankari



**UNITY  
SQUARE**

EXPERIENCE GOOD LIVING





Company registered under companies partnership act 1932 and in the field of construction for the past 12 years. The company is incorporated with the main objects of property development, construction of apartments, commercial complexes & Residential layout project in response to the growing need for quality housing in Bangalore, Hubli, Dharwad & Belgaum.



UNITY INFRASTRUCTURE



Introducing you to a life you've aspired for premium location and comfort living at Unity Square, has been designed and materialized with unique modern contemporary style of architecture, outlined with luxury, Elegant living space and it ensure ample ventilation of air & light into your apartments.

Unity square is centrally located in Banashakari 2nd stage, is Well planned Residential Area Surrounded with Reputed education Institutions, Healthcare, Metro stations & Parks.



NOW

Experience the good Living at **UNITY SQUARE.**





External  
perspectives





# BASEMENT FLOOR

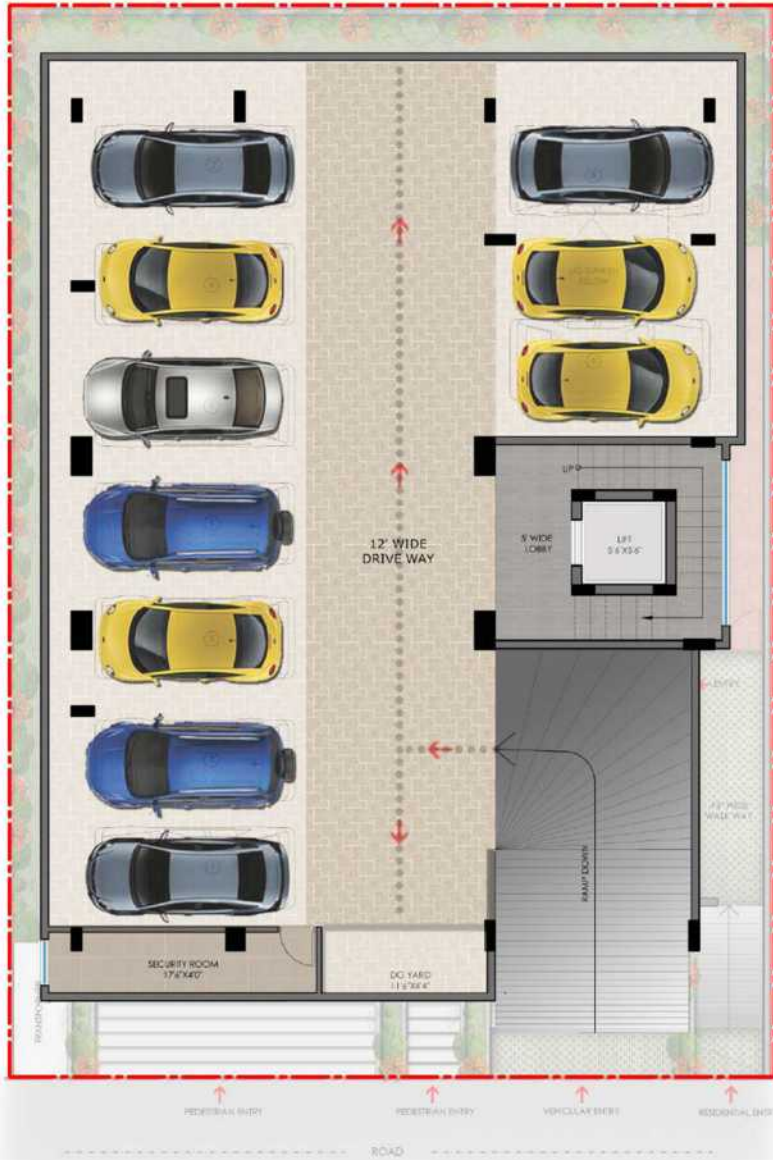

# GROUND FLOOR



G-C1 - 2751.00 SQFT  
 G-C2 - 357.00 SQFT

# Architectural Floor plan



## TYPICAL FLOOR



## TERRACE FLOOR



SALEABLE AREA  
3BHK - 1653.00 SQFT





# UNIT -1



SALEABLE AREA  
 3BHK - 1653.00 SQFT

# UNIT -2



SALEABLE AREA  
 3BHK - 1653.00 SQFT



# ARCHITECTURAL /CIVIL SPECIFICATION



CCTV Camera



100% power backup



Intercom

## STRUCTURE

Basement + Ground floor Commercial and 4 Floor Residential 3BHK apartments.

## CAR PARKING

Covered car parks in basement

## FOYER/LIVING/DINING

Marble finish vitrified tile flooring

Premium Emulsion Paint for walls and ceiling.

## BEDROOMS

Superior Quality vitrified Wooden finish tile flooring in Master Bedroom

Other bedrooms are vitrified flooring

Premium Emulsion Paint for walls and ceiling

## TOILETS

Superior Quality anti-skid ceramic tile flooring

Superior Quality ceramic wall tiling upto 7' height.

## KITCHEN

Natural Engineered stone slab/vitrified tile flooring

Superior Quality ceramic tiling dado from kitchen slab to 4' Height

Premium emulsion paint for ceiling.

## BALCONIES/UTILITIES

Superior quality anti-skid ceramic tile flooring & skirting

Granite coping for parapet/mild steel handrail/glass railing with MS handrail.

Premium emulsion paint for ceiling.

## WINDOWS

MS grill & UPVC 2.5 track Windows.



### **STAIRCASE**

Granite treads & Riser's , textured paint for walls  
Premium emulsion paint for ceiling & MS handrail

### **COMMON AREA**

Granite flooring  
Premium Emulsion for ceiling  
Granite coping for parapet / MS handrail

### **JOINERY**

Main door frame & Shutter-imported teak  
Bedroom door frame - teak & shutters - Hardwood with both side Masonite skin.

### **TOILET DOOR**

Frame- Teak  
Shutter- with Masonite outside & Laminate inside

### **LIFTS**

6 Passenger elevator

### **PLUMBING & SANITARY**

CPVC & PVC is Ashirvad/Astral make  
Sanitary fixtures of reputed make in all toilets  
chromium plated fittings of reputed make in all toilets.

### **ELECTRICAL WORKS**

Split A/C provision in master bedroom  
BESCOM power supply: 3KW 1PHASE supply  
Exhaust fans in kitchen and toilets  
Televisions points in living & master bedroom  
Telephone points in all bedroom, living & family room  
Intercom facility from security cabin to each apartment



Well equipped Gym



Multipurpose Hall



Terrace garden

# ROUTE MAP

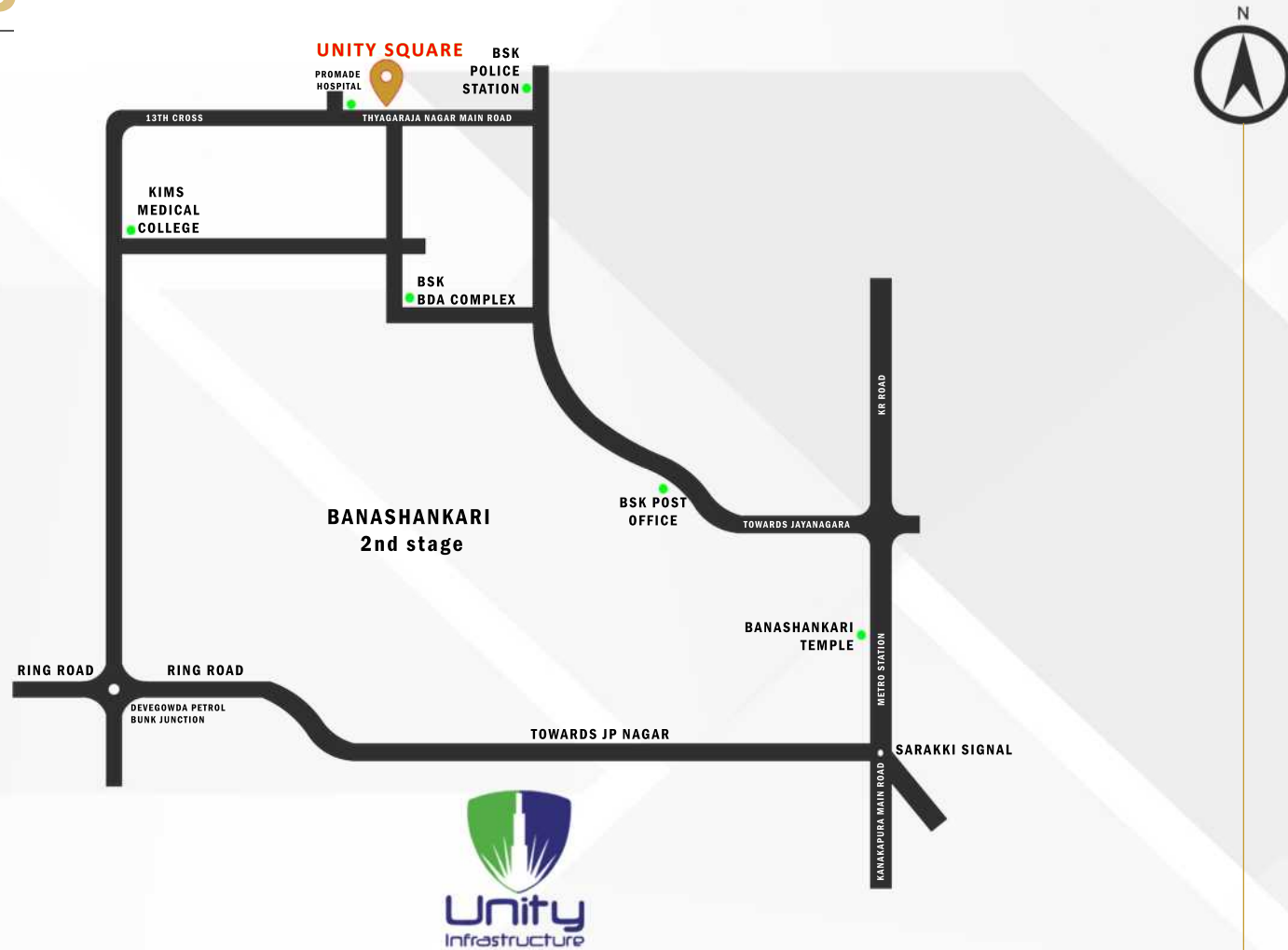

## OFFICE ADDRESS:

#9B, 1st FLOOR, SRINIDHI COMPLEX,  
24th MAIN ROAD, JP NAGAR, 5th PHASE,  
BANGALORE - 560 078

## SITE ADDRESS:

No. 3786 13th CROSS,  
BANASHANKARI 2nd STAGE,  
BANGALORE - 560 070.

PHONE: +9180- 4216 20 55

MOB : +91- 966 3235 353

E-MAIL : [Info@unityinfrastructure.in](mailto:Info@unityinfrastructure.in)

WEB : [www.unityinfrastructure.in](http://www.unityinfrastructure.in)

## Disclaimer:

This Brochure is not legal offering. unity infrastructure reserves the right to change, alter, add or delete any of the specifications and other information mentioned herein without prior permission or notice.